

VIVIENDAS EN OCAÑA

RESIDENCIAL PILAREJO
OCAÑA (TOLEDO)

PORTAL 2
P.: 39- "E"

GARAJE N° ...



CONSTRUCCIONES **PROAL**

TFS: 925-460463
639-172814/6

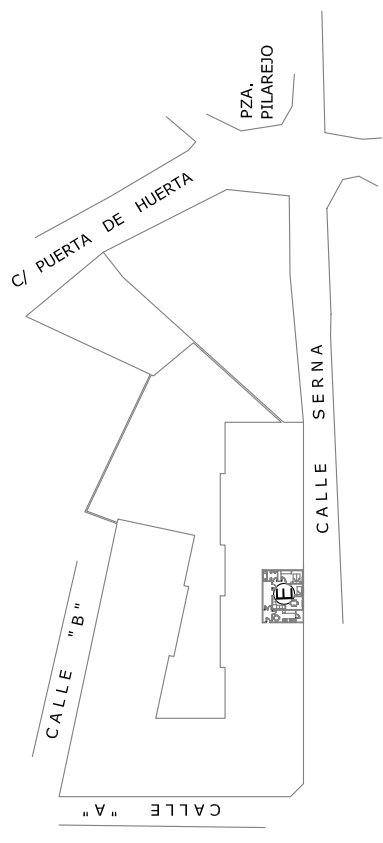
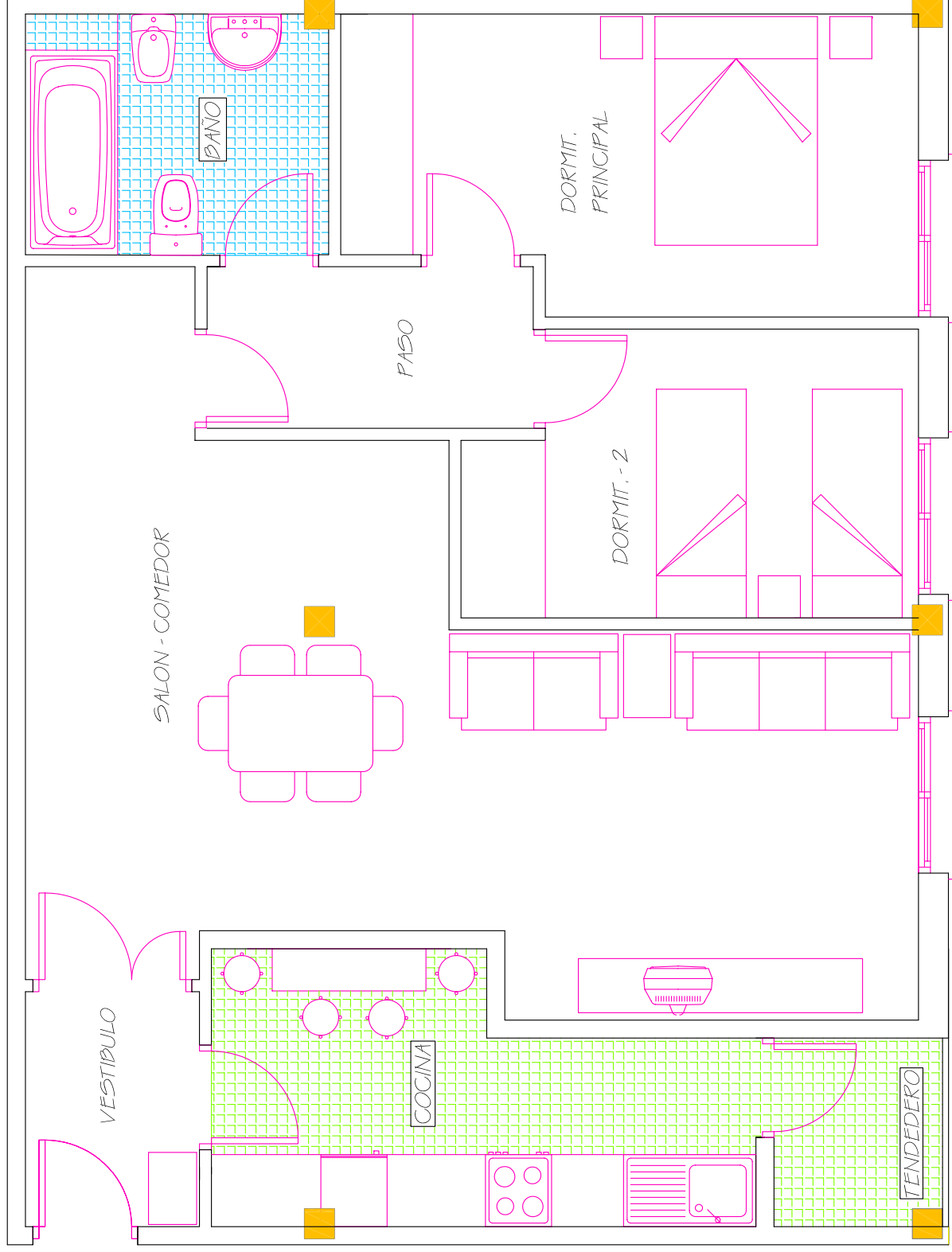

SUPERFICIES ÚTILES

| | |
|------------------------------|----------------------------|
| VESTIBULO | 2.82 m ² |
| SALON-COMEDOR | 31.09 m ² |
| COCINA | 9.32 m ² |
| DORMITORIO-PRINCIPAL | 11.18 m ² |
| DORMITORIO - 2 | 8.49 m ² |
| BAÑO | 5.68 m ² |
| TENDEDERO | 2.19 m ² |
| TOTAL SUP. UTIL | 70.77 m² |
| TOTAL SUP. CONSTRUIDA | 80.00 m² |

ESCALA 1/50